

**nominal voltage:** 1,2V  
**max. charge voltage:** 1,5V

**capacity**  
 nominal : 4500mAh  
 minimum: 3700mAh  
 4200mAh

**max. continuous discharge current:** 4500mA

**charge**  
 standard charge: 450mA  
 rapid charge: 1000mA  
 fast charge: 2250mA

recommended charge termination control parameters:  
 -dV: 0....5mV  
 dT/dt: 0,8....1°C per min  
 TCO: 45....50°C

trickle charge current: 45....225mA (recommended)

continuous overcharge: ≤450mA (less than 1 year)

**internal resistance:** <18mOhms

**life expectancy:** >500 cycles

**ambient temperature range:** 0....45°C  
 10....40°C  
 -20....60°C  
 -20....35°C  
 -20....45°C

conditions  
 at standard charge (0,1C / 20°C)  
 discharge at 0,2C  
 discharge at 1C  
 discharge at 0,2C  
 1,0V end discharge voltage  
 ambient temperature 20°C

ambient temperature 20....50°C

charge current charge time  
 450mA 16hrs at 20°C  
 1000mA 5hrs  
 2250mA 2,2hrs

at 1000Hz, battery fully charged

IEC standard

standard charge  
 fast charge  
 discharge  
 storage less than 6 months  
 storage less than 1 month

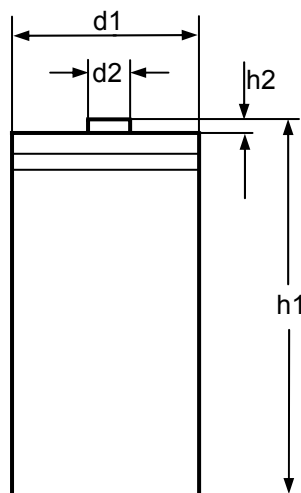
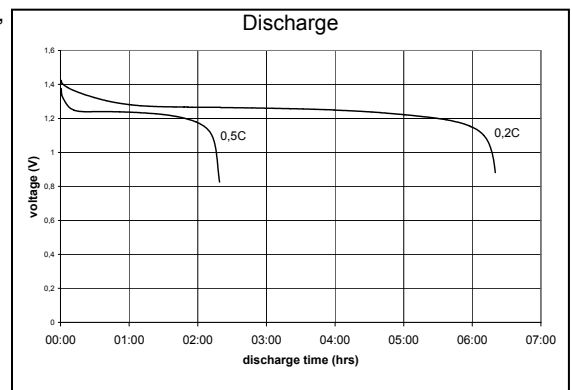
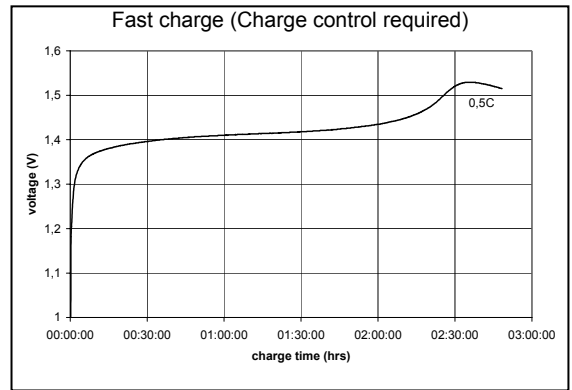
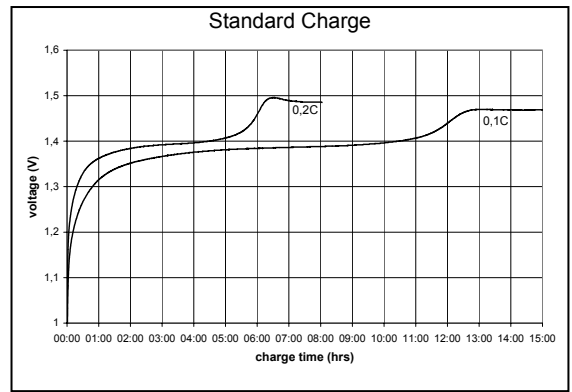

**mechanical specifications**  
 cell dimensions (with sleeve)  
 diameter d1: 26,0 – 1,0mm  
 diameter d2: 7,5 - 2,5mm  
 height h1: 50,0 -1,5mm  
 height h2: min. 1,5mm  
 weight: approx. 80g

	specifications for model/type:	C – NiMH 4500mAh
	Ansmann drawing number / part number:	5030621
	drawn by / date:	Gramlich / 27.12.2005